

Maps 7-10 &20

Maps 3-6 &13

Maps 14-17 &21

Maps 18,19 &22-26

Maps 33&34

Maps 29&30

Maps 27&28

32

31

2

1

12

11

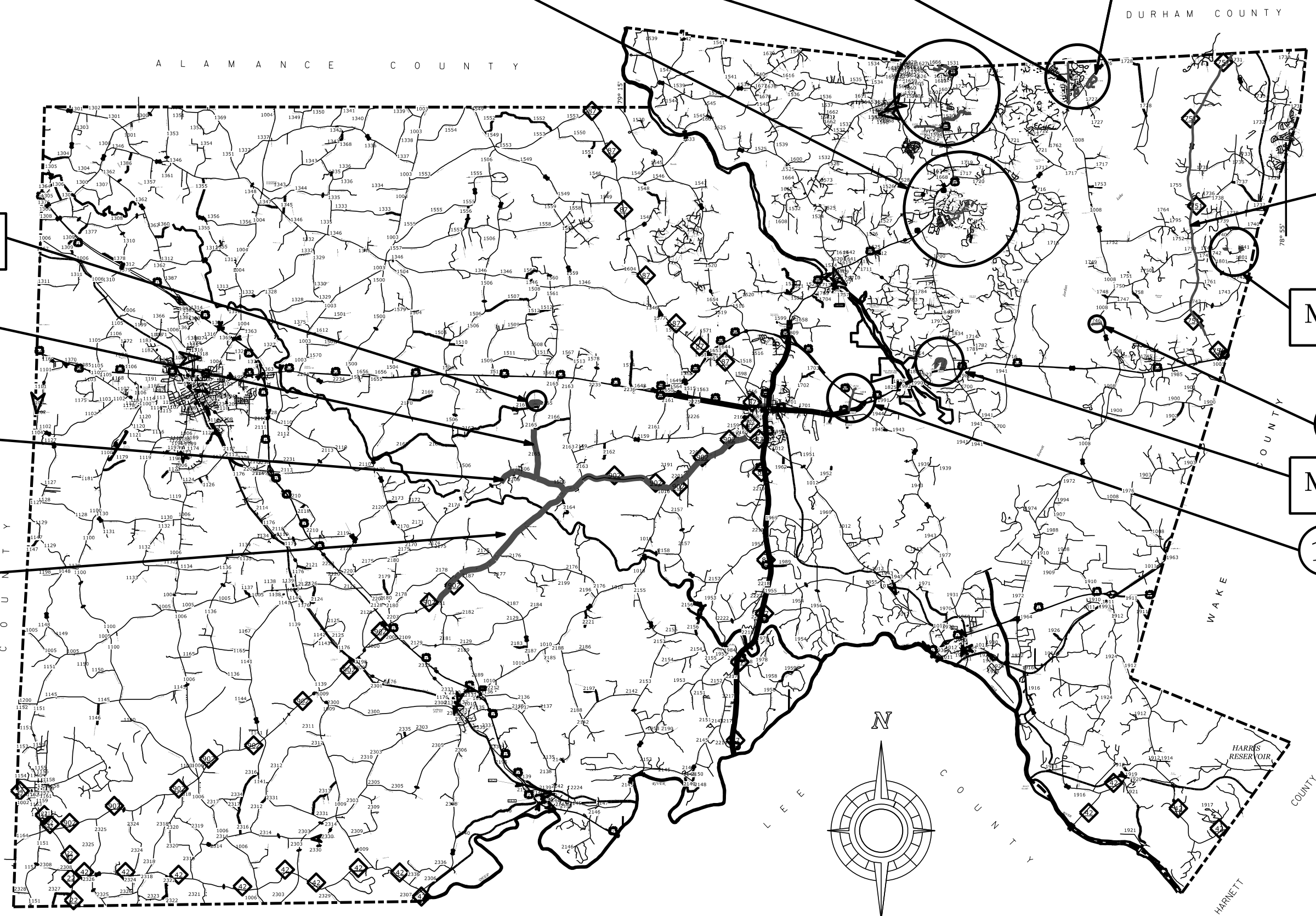

CHATHAM COUNTY
ASPHALT SURFACE TREATMENT

SUNLINE

Map 1

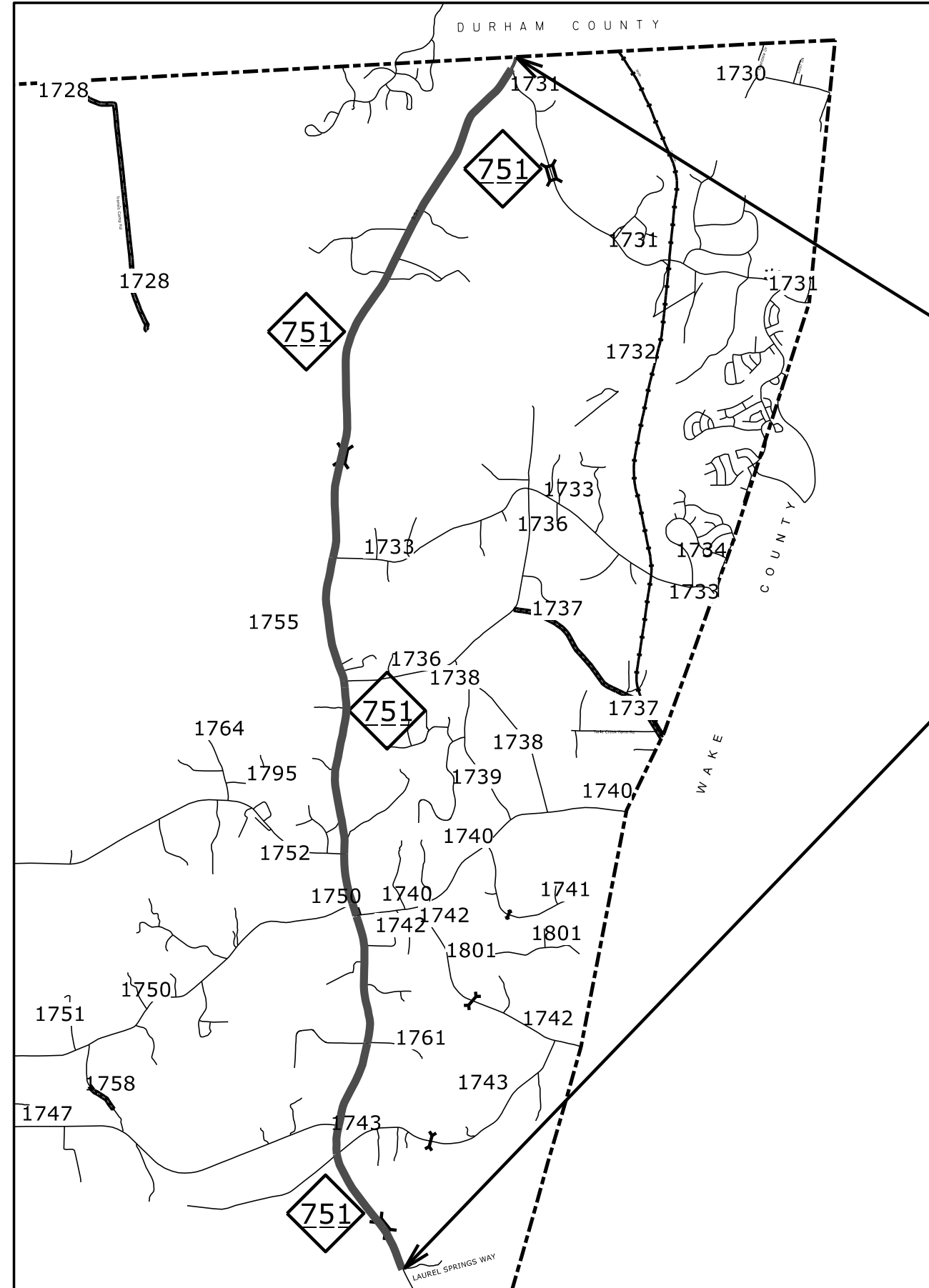

1



CHATHAM COUNTY
NORTH CAROLINA
PREPARED BY THE
NORTH CAROLINA DEPARTMENT OF TRANSPORTATION
DIVISION OF HIGHWAYS

2026CPT.08.05.10192
2026CPT.08.05.20192

Maps 3-6 & 13

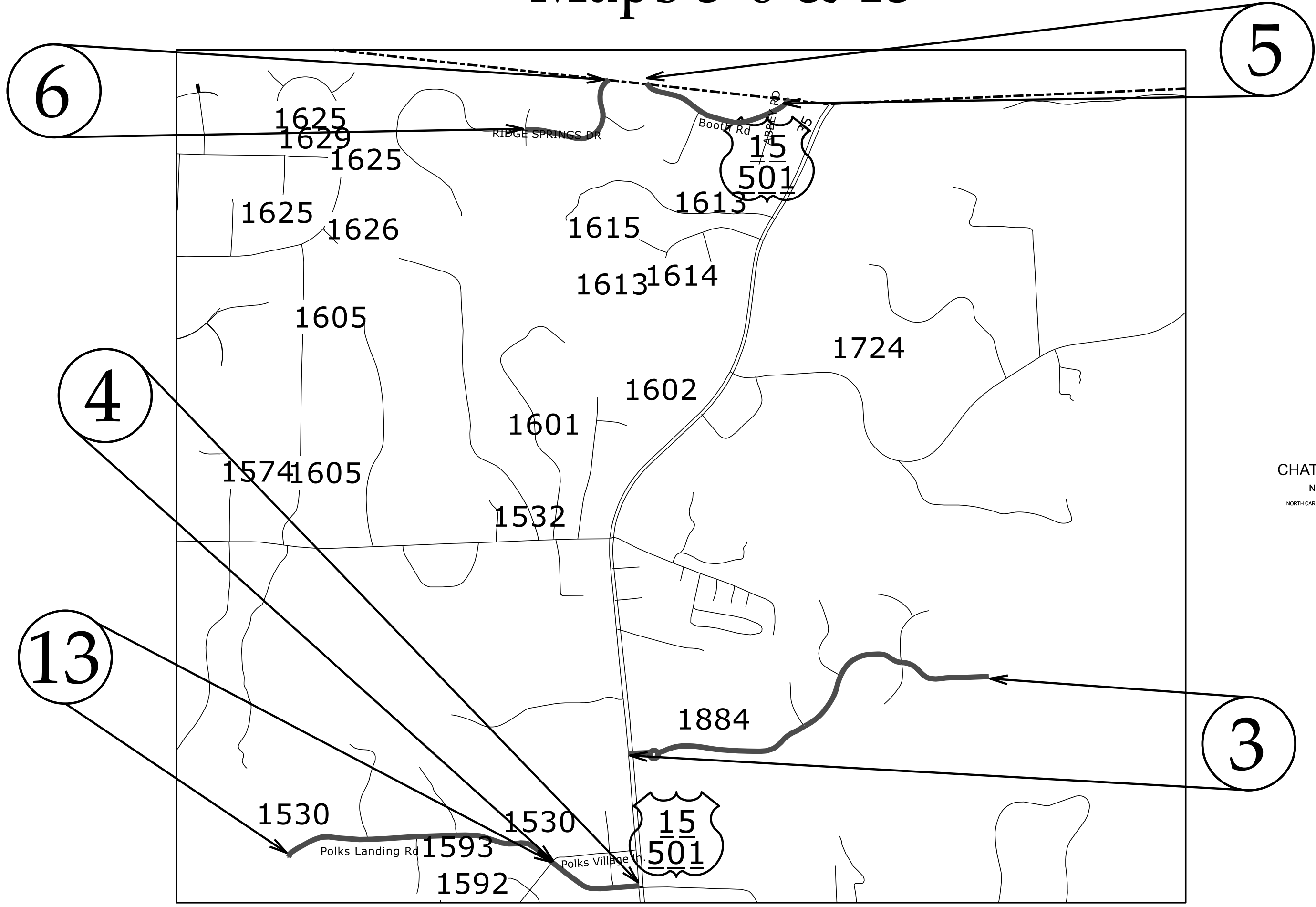

CHATHAM COUNTY
NORTH CAROLINA
PREPARED BY THE
NORTH CAROLINA DEPARTMENT OF TRANSPORTATION
DIVISION OF HIGHWAYS

2025 RELEASE UNDER E.O. 14176

Maps 29 & 30

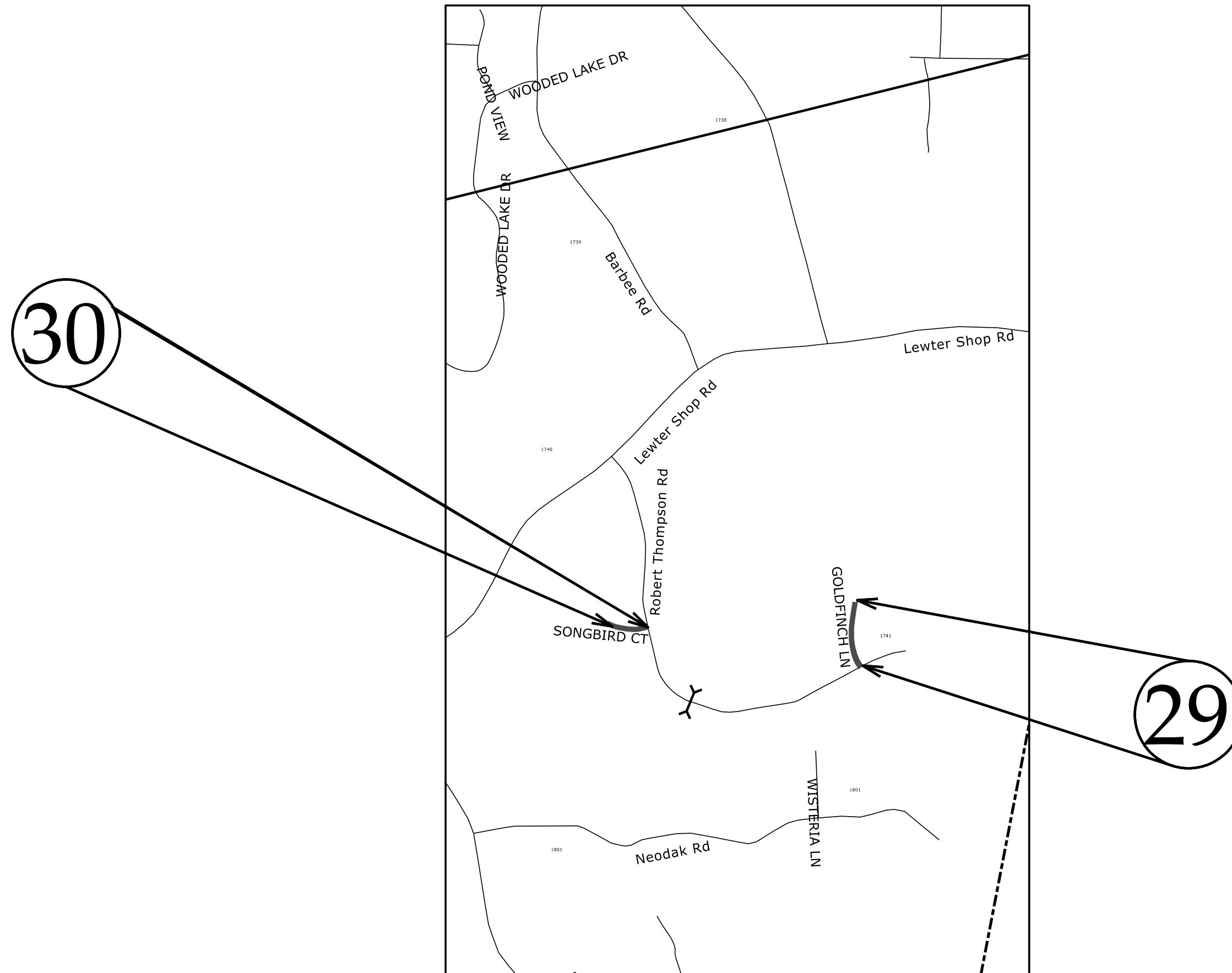

CHATHAM COUNTY
NORTH CAROLINA
PREPARED BY THE
NORTH CAROLINA DEPARTMENT OF TRANSPORTATION
DIVISION OF HIGHWAYS

\$\$\$\$\$
SYTIME
L
\$\$\$\$\$

Maps 31 & 32

32

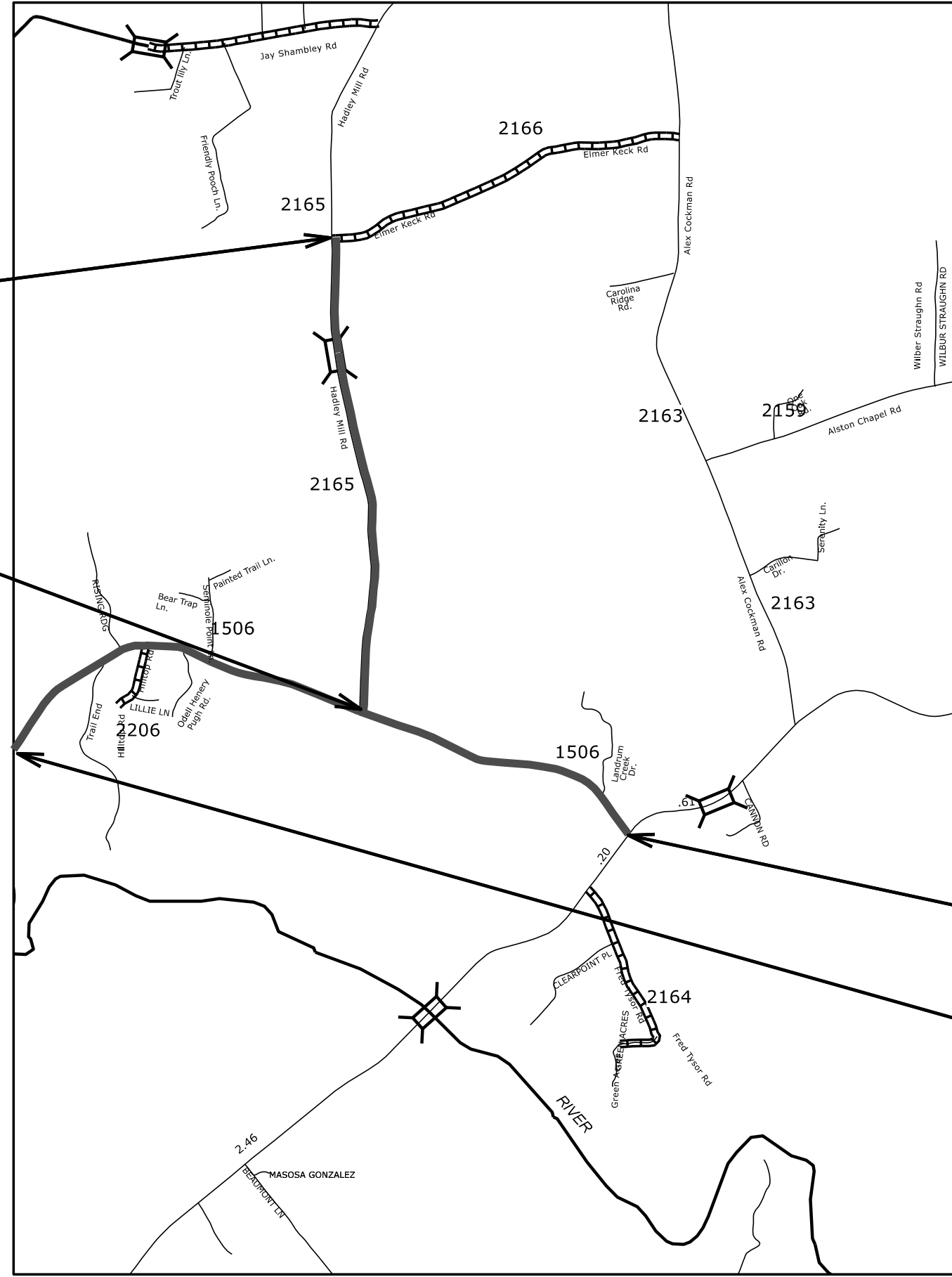

31

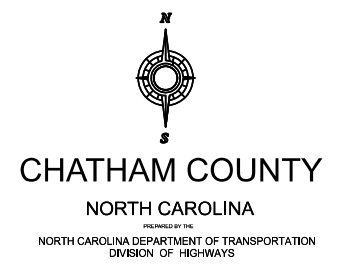

SYTIME
2025/08/05 10:19:22
2025/08/05 20:19:22

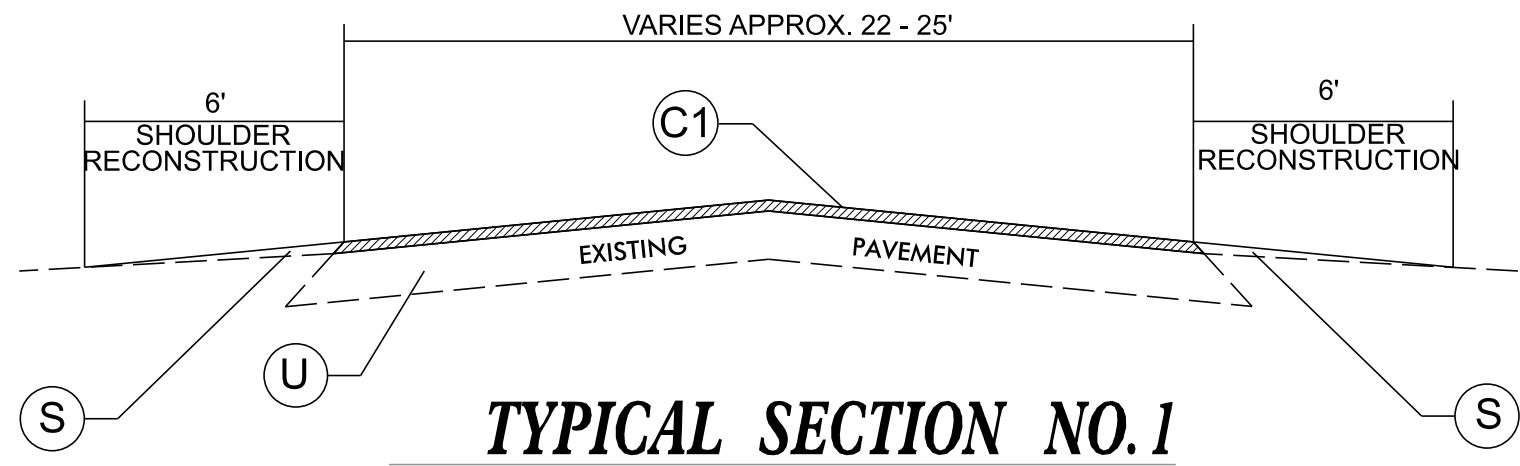

TYPICAL SECTION NO. 1

USE FOR MAPS 3-11 & 27-30

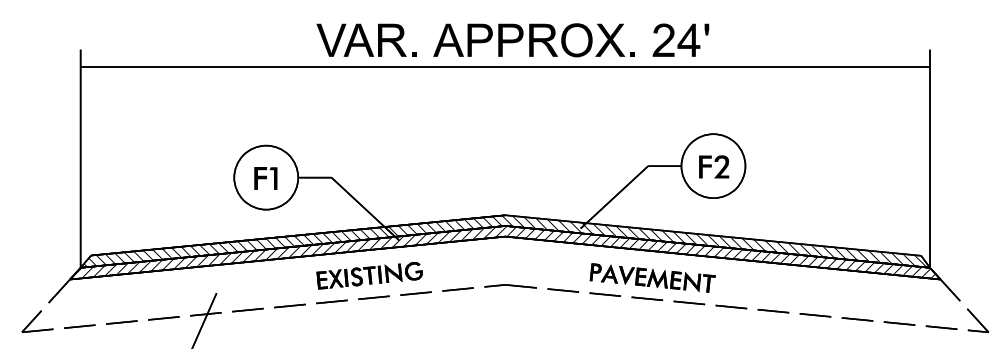

TYPICAL SECTION NO. 2

USE FOR MAPS 12, 13, 31, & 32

| PAVEMENT SCHEDULE | |
|-------------------|---|
| C1 | PROP. APPROX. 1.25" ASPHALT CONCRETE SURFACE COURSE, TYPE S9.5B, AT AN AVERAGE RATE OF 138 LBS. PER SQ. YD. |
| F1 | PROP. ASPHALT TREATMENT DOUBLE SEAL |
| F2 | PROPOSED ASPHALT TREATMENT FOG SEAL |
| U | EXISTING PAVEMENT |

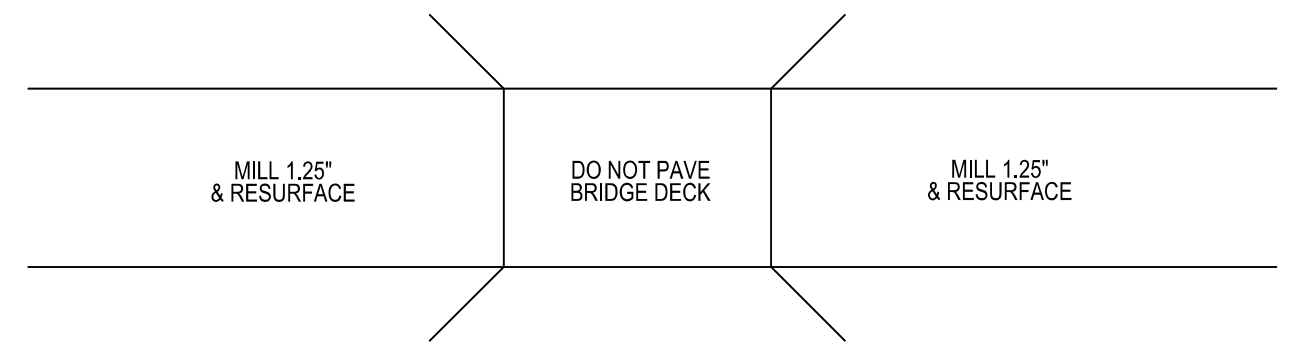

**BRIDGE DRAWING FOR
 MAP #11 SR 1572**

\$\$\$
 2026CPT.08.05.10192
 2026CPT.08.05.20192
 \$\$\$

SIGNING FOR ASPHALT SURFACE TREATMENT

LEGEND

- ⏏ PORTABLE SIGN
- ┌ STATIONARY SIGN
- ← DIRECTION OF TRAFFIC FLOW

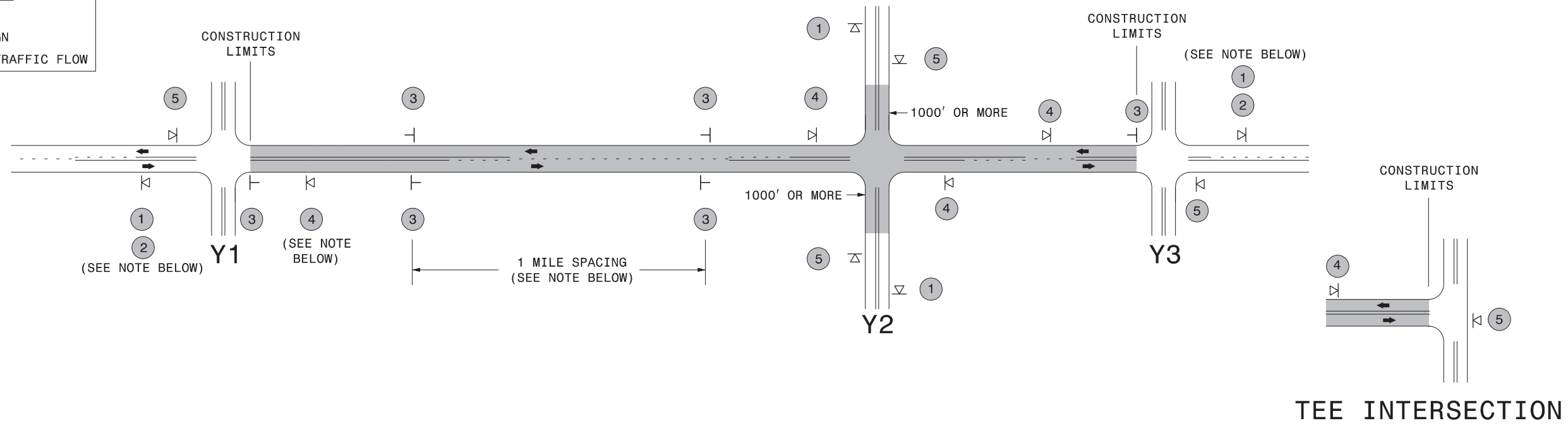

MAINLINE (-L-) SIGNING

-Y- LINE SIGNING

| | | | | |
|--|---|------|--|--|
| SIGNING NOTES AND PLACEMENT PER DIRECTION | 1 | | <ul style="list-style-type: none"> - PLACE 1000' PRIOR TO BEGINNING OF CONSTRUCTION LIMITS. ONLY USED ON -Y- LINES IF RESURFACING LIMITS EXTEND 1000' ALONG -Y- LINE. - SIGN #2 ONLY USED WHEN RESURFACING LIMITS ARE 2 OR MORE MILES IN LENGTH. ROUND UP TO THE NEAREST WHOLE NUMBER. DO NOT USE FRACTIONAL OR DECIMAL NUMBERS. | <p>STATIONARY SIGNING NOT REQUIRED FOR THE FOLLOWING -Y- LINE CONDITIONS:</p> <ol style="list-style-type: none"> 1) LESS THAN 1000' OF RESURFACING ALONG -Y- LINE 2) SUBDIVISION ROADS 3) DEAD END ROADS <p>WHEN PAVING/CONSTRUCTION ACTIVITIES PROCEED ACROSS AN UNSIGNED -Y- LINE, PORTABLE ADVANCE WARNING SIGNS SHALL BE USED ALONG THE -Y- LINE AS SHOWN BELOW. REMOVE UPON COMPLETION OF WORK.</p> <div style="display: flex; justify-content: space-around; align-items: center;"> <div style="text-align: center;"> <small>W20-1 48" X 48"</small> PLACED 500' IN ADVANCE OF FLAGGER. </div> <div style="text-align: center;"> <small>W20-7 A 48" X 48"</small> PLACED 250' IN ADVANCE OF FLAGGER. </div> </div> |
| | 3 | | <ul style="list-style-type: none"> - ALTERNATE THE FOLLOWING TWO SIGNS: - STARTING WITH "LOOSE GRAVEL" (W8-7) FOLLOWED BY "UNMARKED PAVEMENT". - PLACE INITIALLY AT THE CONSTRUCTION LIMITS AND SPACED 1 MILE APART THEREAFTER. - AT TEE INTERSECTIONS INSTALL INITIALLY 0.5 MILE FROM INTERSECTION AND SPACE 1 MILE APART THEREAFTER. | |
| | 4 | | <ul style="list-style-type: none"> - THESE ARE FOR -Y- LINES THAT ARE "THROUGH" ROADWAYS. DEAD END AND SUBDIVISION ROADS ARE NOT "THROUGH" ROADWAYS. - INSTALL 500' +/- FROM EACH -Y- LINE APPROACH AS SHOWN ABOVE. - FOR MULTIPLE -Y- LINES THAT ARE SEPARATED BY 0.25 MILES OR LESS, TREAT AS A SINGLE UNIT AND INSTALL WITHIN 500' OF EACH APPROACH. - A MAXIMUM OF 2 SIGN SETS PER MILE. DO NOT INSTALL WHEN -Y- LINES ARE WITHIN 0.5 MILES FROM "END ROAD WORK" SIGN. | |
| | 5 | | <ul style="list-style-type: none"> - PLACE 500' FOLLOWING THE END OF CONSTRUCTION LIMITS OR AS SHOWN WHEN WORK ENDS AT A 3-WAY TEE INTERSECTION. | |
| | <p>THE ABOVE SIGNS ARE ALL THAT ARE REQUIRED FOR A CONTRACTOR TO BEGIN A RESURFACING CONTRACT. ANY ADDITIONAL SIGNS REQUESTED BY NCDOT DIVISIONS SHALL BE INSTALLED WITHIN 7 BUSINESS DAYS OF THE START OF CONTRACT WORK.</p> | | | |

MAPS LESS THAN 2 MILES

FOR AST RESURFACING MAPS WITH CONSTRUCTION LIMITS LESS THAN 2 MILES IN LENGTH, USE A STATIONARY "LOOSE GRAVEL" SIGN AT THE BEGINNING CONSTRUCTION LIMIT FOLLOWED BY AN "UNMARKED PAVEMENT" SIGN MIDWAY THROUGH AND AN "END ROAD WORK" SIGN AT THE END CONSTRUCTION LIMIT.

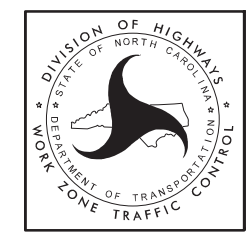

**ADVANCE WARNING SIGNS
FOR
2-LANE ROADWAY
ASPHALT SURFACE TREATMENT**

5/12/2017 S:\TUXWZTC\Resurfacing\2L2W & AST Resurfacing Details\Resurfacing_AdvWarn_2Ln - AST.dgn User:kedais

| | | |
|---|-----------|-----------|
| PROJECT NO. | SHEET NO. | TOTAL NO. |
| 2026CPT.08.05.20192, 2026CPT.08.05.20192 | 17 | |

SUMMARY OF QUANTITIES

| PROJECT NO | COUNTY | MAP NO | ROUTE | DESCRIPTION | TYP NO | LANES | LANE TYPE | LENGTH | WIDTH | BEGIN MP | END MP | 1022000000-E | 1245000000-E | 1260000000-E | 1330000000-E | 1519000000-E | 1575000000-E | 1803500000-E | 1820000000-E | 1838000000-E | 1838500000-N | 2830000000-N | 2845000000-N | | | | | | | | | | | |
|---|---------|--------|-----------------------------------|---|--------|-------|-----------|--------|-------|----------|--------|---|-------------------------|---------------------------|--------------------|-----------------------|------------------------------|--|-------------------------------------|--|--------------|-----------------|---------------------------|--------------|---------------|------------|--------------|------------|------------------|------------------|---------------|-------------|----------|----------|
| | | | | | | | | | | | | SEALING EXISTING PAVEMENT CRACKS & JOINTS | SHOULDER RECONSTRUCTION | AGGREGATE SHOULDER BORROW | INCIDENTAL MILLING | SURFACE COURSE, S9.5B | ASPHALT BINDER FOR PLANT MIX | ASPHALT SURFACE TREATMENT, DOUBLE SEAL | ASPHALT SURFACE TREATMENT, FOG SEAL | EMULSION FOR ASPHALT SURFACE TREATMENT | VACUUM TRUCK | ADJUST MANHOLES | ADJUST METER OR VALVE BOX | | | | | | | | | | | |
| | | | | | | | | | | | | MI | FT | | | | | | | | | | | | | | | | | | | | | |
| | | | | | | | | | | | | LB | SMI | TON | SY | TONS | TONS | SY | SY | GAL | WK | EA | EA | | | | | | | | | | | |
| 2026CPT.08.05.20192 | Chatham | 20 | SR-1875 / STONEVIEW | FROM SR 1868 HAMMOCK BEND TO CUL DE SAC | | 2 | 2WU | 0.157 | 21 | 0.000 | 0.157 | 450.00 | | | | | | | | | | | | | | | | | | | | | | |
| TOTAL FOR MAP NO. 20 | | | | | | | | | | | | 0.157 | | | | | | | | | | | | | | | | | | | | | | |
| 2026CPT.08.05.20192 | Chatham | 21 | SR-1008 / MT CARMEL CHURCH RD | FROM SR 1726 OLD FARRINGTON ROAD TO ORANGE COUNTY | | 2 | 2WU | 1.178 | 20 | 14.800 | 15.978 | 3,300.00 | | | | | | | | | | | | | | | | | | | | | | |
| TOTAL FOR MAP NO. 21 | | | | | | | | | | | | 1.178 | | | | | | | | | | | | | | | | | | | | | | |
| 2026CPT.08.05.20192 | Chatham | 22 | SR-1867 / RAINTREE BND | FROM SR 1865 TWIN BRANCH TO CUL DE SAC | | 2 | 2WU | 0.200 | 19 | 0.000 | 0.200 | 650.00 | | | | | | | | | | | | | | | | | | | | | | |
| TOTAL FOR MAP NO. 22 | | | | | | | | | | | | 0.200 | | | | | | | | | | | | | | | | | | | | | | |
| 2026CPT.08.05.20192 | Chatham | 23 | SR-1868 / HAMMOCK BND | FROM SR 1865 TWIN BRANCH TO SR 1866 ADIRONDACK TRAIL | | 2 | 2WU | 0.520 | 22 | 0.000 | 0.520 | 1,475.00 | | | | | | | | | | | | | | | | | | | | | | |
| TOTAL FOR MAP NO. 23 | | | | | | | | | | | | 0.520 | | | | | | | | | | | | | | | | | | | | | | |
| 2026CPT.08.05.20192 | Chatham | 24 | SR-1866 / ADIRONDACK WAY | FROM SR 1865 TWIN BRANCH TO CUL DE SAC | | 2 | 2WU | 0.210 | 21 | 0.000 | 0.210 | 600.00 | | | | | | | | | | | | | | | | | | | | | | |
| TOTAL FOR MAP NO. 24 | | | | | | | | | | | | 0.210 | | | | | | | | | | | | | | | | | | | | | | |
| 2026CPT.08.05.20192 | Chatham | 25 | SR-1883 / VAIL DR | FROM SR 1868 HAMMOCK BEND TO CUL DE SAC | | 2 | 2WU | 0.124 | 20 | 0.000 | 0.124 | 350.00 | | | | | | | | | | | | | | | | | | | | | | |
| TOTAL FOR MAP NO. 25 | | | | | | | | | | | | 0.124 | | | | | | | | | | | | | | | | | | | | | | |
| 2026CPT.08.05.20192 | Chatham | 26 | SR-1865 / TWIN BRANCH LN | FROM SR 1726 WHIPPOORWHILL TO SR 1868 HAMMOCK BEND | | 2 | 2WU | 0.130 | 24 | 0.000 | 0.130 | 475.00 | | | | | | | | | | | | | | | | | | | | | | |
| TOTAL FOR MAP NO. 26 | | | | | | | | | | | | 0.130 | | | | | | | | | | | | | | | | | | | | | | |
| 2026CPT.08.05.20192 | Chatham | 27 | SR-1878 / HENRYS RIDGE RD | FROM SR 1822 (HENRY WEBSTER RD) TO CUL DE SAC | 1 | 2 | 2WU | 0.672 | 20 | 0.000 | 0.672 | | 1.34 | 188 | | 599 | 39 | | | | | | | | | | | | | | | | | |
| TOTAL FOR MAP NO. 27 | | | | | | | | | | | | 0.672 | | | | | 1.34 | 188 | | 599 | 39 | | | | | | | | | | | | | |
| 2026CPT.08.05.20192 | Chatham | 28 | SR-1897 / HENRY'S HILL LN | FROM SR 1878 (HENRYS RIDGE) TO CUL DE SAC | 1 | 2 | 2WU | 0.054 | 20 | 0.000 | 0.054 | | 0.11 | 15 | | 77 | 5 | | | | | | | | | | | | | | | | | |
| TOTAL FOR MAP NO. 28 | | | | | | | | | | | | 0.054 | | | | | 0.11 | 15 | | 77 | 5 | | | | | | | | | | | | | |
| 2026CPT.08.05.20192 | Chatham | 29 | SR-1895 / GOLDFINCH LN | FROM SR 1741 (THOMPSON RD) TO CUL DE SAC | 1 | 2 | 2WU | 0.127 | 19 | 0.000 | 0.127 | | 0.25 | 36 | | 129 | 8 | | | | | | | | | | | | | | | | | |
| TOTAL FOR MAP NO. 29 | | | | | | | | | | | | 0.127 | | | | | 0.25 | 36 | | 129 | 8 | | | | | | | | | | | | | |
| 2026CPT.08.05.20192 | Chatham | 30 | SR-1896 / SONGBIRD CT | FROM SR 1741 (THOMPSON RD) TO CUL DE SAC | 1 | 2 | 2WU | 0.077 | 19 | 0.000 | 0.077 | | 0.15 | 22 | | 95 | 6 | | | | | | | | | | | | | | | | | |
| TOTAL FOR MAP NO. 30 | | | | | | | | | | | | 0.077 | | | | | 0.15 | 22 | | 95 | 6 | | | | | | | | | | | | | |
| 2026CPT.08.05.20192 | Chatham | 31 | SR-1506 / PLEASANT HILL CHURCH RD | FROM NC 902 TO END PVT | 2 | 2 | 2WU | 1.791 | 20 | 0.000 | 1.791 | | | | | | | 21,050.00 | | 11,580 | | | | | | | | | | | | | | |
| TOTAL FOR MAP NO. 31 | | | | | | | | | | | | 1.791 | | | | | | | | | | | 21,050.00 | | 11,580 | | | | | | | | | |
| 2026CPT.08.05.20192 | Chatham | 32 | SR-2165 / HADLEY MILL RD | FROM SR 2166 (ELMER KECK RD) TO SR 1506 (PLEASANT HILL CH RD) | 2 | 2 | 2WU | 1.408 | 20 | 1.781 | 3.189 | | | | | | | 16,525.00 | | 9,090 | | | | | | | | | | | | | | |
| TOTAL FOR MAP NO. 32 | | | | | | | | | | | | 1.408 | | | | | | | | | | | 16,525.00 | | 9,090 | | | | | | | | | |
| 2026CPT.08.05.20192 | Chatham | 33 | SR-2239 / SHAMBLEY MEADOWS DR | FROM SR 2165 (HADLEY MILL RD) TO SR 2167 (JAY SHAMBLEY RD) | | 2 | 2WU | 0.406 | 20 | 0.000 | 0.406 | 1,400.00 | | | | | | | | | | | | | | | | | | | | | | |
| TOTAL FOR MAP NO. 33 | | | | | | | | | | | | 0.406 | | | | | | | | | | | 1,400.00 | | | | | | | | | | | |
| 2026CPT.08.05.20192 | Chatham | 34 | SR-2238 / BLARNEY STONE CIR | FROM SR 2239 (SHAMBELY MEADOWS) TO CUL DE SAC | | 2 | 2WU | 0.057 | 20 | 0.000 | 0.057 | 200.00 | | | | | | | | | | | | | | | | | | | | | | |
| TOTAL FOR MAP NO. 34 | | | | | | | | | | | | 0.057 | | | | | | | | | | | 200.00 | | | | | | | | | | | |
| TOTAL FOR PROJ NO. 2026CPT.08.05.20192 | | | | | | | | | | | | 13.360 | | | | | | | | | | | 11,125.00 | 10.93 | 1,530 | 350 | 4,779 | 310 | 48,495.00 | 10,920.00 | 26,672 | 3.00 | 4 | 7 |
| GRAND TOTAL | | | | | | | | | | | | 32.674 | | | | | | | | | | | 68,625.00 | 10.93 | 1,530 | 350 | 4,779 | 310 | 48,495.00 | 10,920.00 | 26,672 | 3.00 | 4 | 7 |

| | | |
|---|-----------|-----------|
| PROJECT NO. | SHEET NO. | TOTAL NO. |
| 2026CPT.08.05.10192, 2026CPT.08.05.20192 | 19 | |

THERMOPLASTIC AND PAINT QUANTITIES

| PROJECT NO | COUNTY | MAP NO | ROUTE | DESCRIPTION | TYP NO | LANES | LANE TYPE | LENGTH | WIDTH | BEGIN MP | END MP | 4413000000-E | 4457000000-N | 4815000000-E | | 4820000000-E | 4835000000-E | | |
|---|---------|--------|-----------------------------------|--|--------|-------|-----------|--------------|-------|----------|--------|--|---------------------------------|--------------------|-------------------|-------------------|--------------------|------------|-----------|
| | | | | | | | | | | | | WORK ZONE ADVANCE/GE NERAL WARNING SIGNING | TEMPORARY TRAFFIC CONTROL | 6" YELLOW PAINT | 6" WHITE PAINT | 8" WHITE PAINT | 24" WHITE PAINT | | |
| | | | | | | | | | | | | SF | LS | LF | LF | LF | LF | | |
| 2026CPT.08.05.20192 | Chatham | 18 | SR-1869 / CRYSTAL CV | FROM SR 1868 HAMMOCK BEND TO CUL DE SAC | | 2 | 2WU | 0.046 | 21 | 0 | 0.046 | | | | | | | | |
| TOTAL FOR MAP NO. 18 | | | | | | | | 0.046 | | | | | | | | | | | |
| 2026CPT.08.05.20192 | Chatham | 19 | SR-1870 / SAND CREEK CT | FROM SR 1868 HAMMOCK BEND TO CUL DE SAC | | 2 | 2WU | 0.029 | 21 | 0 | 0.029 | | | | | | | | |
| TOTAL FOR MAP NO. 19 | | | | | | | | 0.029 | | | | | | | | | | | |
| 2026CPT.08.05.20192 | Chatham | 20 | SR-1875 / STONEVIEW | FROM SR 1868 HAMMOCK BEND TO CUL DE SAC | | 2 | 2WU | 0.157 | 21 | 0 | 0.157 | | | | | | | | |
| TOTAL FOR MAP NO. 20 | | | | | | | | 0.157 | | | | | | | | | | | |
| 2026CPT.08.05.20192 | Chatham | 21 | SR-1008 / MT CARMEL CHURCH RD | FROM SR 1726 OLD FARRINGTON ROAD TO ORANGE COUNTY | | 2 | 2WU | 1.178 | 20 | 14.8 | 15.978 | | | | | | | | |
| TOTAL FOR MAP NO. 21 | | | | | | | | 1.178 | | | | | | | | | | | |
| 2026CPT.08.05.20192 | Chatham | 22 | SR-1867 / RAINTREE BND | FROM SR 1865 TWIN BRANCH TO CUL DE SAC | | 2 | 2WU | 0.2 | 19 | 0 | 0.2 | | | | | | | | |
| TOTAL FOR MAP NO. 22 | | | | | | | | 0.2 | | | | | | | | | | | |
| 2026CPT.08.05.20192 | Chatham | 23 | SR-1868 / HAMMOCK BND | FROM SR 1865 TWIN BRANCH TO SR 1866 ADIRONDACK TRAIL | | 2 | 2WU | 0.52 | 22 | 0 | 0.52 | | | | | | | | |
| TOTAL FOR MAP NO. 23 | | | | | | | | 0.52 | | | | | | | | | | | |
| 2026CPT.08.05.20192 | Chatham | 24 | SR-1866 / ADIRONDACK WAY | FROM SR 1865 TWIN BRANCH TO CUL DE SAC | | 2 | 2WU | 0.21 | 21 | 0 | 0.21 | | | | | | | | |
| TOTAL FOR MAP NO. 24 | | | | | | | | 0.21 | | | | | | | | | | | |
| 2026CPT.08.05.20192 | Chatham | 25 | SR-1883 / VAIL DR | FROM SR 1868 HAMMOCK BEND TO CUL DE SAC | | 2 | 2WU | 0.124 | 20 | 0 | 0.124 | | | | | | | | |
| TOTAL FOR MAP NO. 25 | | | | | | | | 0.124 | | | | | | | | | | | |
| 2026CPT.08.05.20192 | Chatham | 26 | SR-1865 / TWIN BRANCH LN | FROM SR 1726 WHIPPOORWHILL TO SR 1868 HAMMOCK BEND | | 2 | 2WU | 0.13 | 24 | 0 | 0.13 | | | | | | | | |
| TOTAL FOR MAP NO. 26 | | | | | | | | 0.13 | | | | | | | | | | | |
| 2026CPT.08.05.20192 | Chatham | 27 | SR-1878 / HENRYS RIDGE RD | FROM SR 1822 (HENRY WEBSTER RD) TO CUL DE SAC | 1 | 2 | 2WU | 0.672 | 20 | 0 | 0.672 | 80 | | | | | | | |
| TOTAL FOR MAP NO. 27 | | | | | | | | 0.672 | | | | 80 | | | | | | | |
| 2026CPT.08.05.20192 | Chatham | 28 | SR-1897 / HENRY'S HILL LN | FROM SR 1878 (HENRYS RIDGE) TO CUL DE SAC | 1 | 2 | 2WU | 0.054 | 20 | 0 | 0.054 | 10 | | | | | | | |
| TOTAL FOR MAP NO. 28 | | | | | | | | 0.054 | | | | 10 | | | | | | | |
| 2026CPT.08.05.20192 | Chatham | 29 | SR-1895 / GOLDFINCH LN | FROM SR 1741 (THOMPSON RD) TO CUL DE SAC | 1 | 2 | 2WU | 0.127 | 19 | 0 | 0.127 | 15 | | | | | | | |
| TOTAL FOR MAP NO. 29 | | | | | | | | 0.127 | | | | 15 | | | | | | | |
| 2026CPT.08.05.20192 | Chatham | 30 | SR-1896 / SONGBIRD CT | FROM SR 1741 (THOMPSON RD) TO CUL DE SAC | 1 | 2 | 2WU | 0.077 | 19 | 0 | 0.077 | 10 | | | | | | | |
| TOTAL FOR MAP NO. 30 | | | | | | | | 0.077 | | | | 10 | | | | | | | |
| 2026CPT.08.05.20192 | Chatham | 31 | SR-1506 / PLEASANT HILL CHURCH RD | FROM NC 902 TO END PVT | 2 | 2 | 2WU | 1.791 | 20 | 0 | 1.791 | 205 | | 18,920 | 18,920 | | | | |
| TOTAL FOR MAP NO. 31 | | | | | | | | 1.791 | | | | 205 | | 18,920 | 18,920 | | | | |
| 2026CPT.08.05.20192 | Chatham | 32 | SR-2165 / HADLEY MILL RD | FROM SR 2166 (ELMER KECK RD) TO SR 1506 (PLEASANT HILL CH RD) | 2 | 2 | 2WU | 1.408 | 20 | 1.781 | 3.189 | 160 | | 14,900 | 14,900 | | | | |
| TOTAL FOR MAP NO. 32 | | | | | | | | 1.408 | | | | 160 | | 14,900 | 14,900 | | | | |
| 2026CPT.08.05.20192 | Chatham | 33 | SR-2239 / SHAMBLEY MEADOWS DR | FROM SR 2165 (HADLEY MILL RD) TO SR 2167 (JAY SHAMBLEY RD) | | 2 | 2WU | 0.406 | 20 | 0 | 0.406 | | | | | | | | |
| TOTAL FOR MAP NO. 33 | | | | | | | | 0.406 | | | | | | | | | | | |
| 2026CPT.08.05.20192 | Chatham | 34 | SR-2238 / BLARNEY STONE CIR | FROM SR 2239 (SHAMBELY MEADOWS) TO CUL DE SAC | | 2 | 2WU | 0.057 | 20 | 0 | 0.057 | | | | | | | | |
| TOTAL FOR MAP NO. 34 | | | | | | | | 0.057 | | | | | | | | | | | |
| TOTAL FOR PROJ NO. 2026CPT.08.05.20192 | | | | | | | | 13.36 | | | | | | 1,130 | 1,000 | 65,930 | 65,930 | 240 | 50 |
| | | | | | | | | | | | | | | 131,860 | | | | | |
| GRAND TOTAL | | | | | | | | | | | | | | 1,130 | 1,000 | 65,930 | 65,930 | 240 | 50 |
| | | | | | | | | | | | | | | 131,860 | | | | | |